

- PB-1** | T型槽轉換C型槽之固定座，適用於FESTO尺寸溝槽。
- PB-13** | PB-1用於固定LYD-07、LYD-81、LYD-81V系列的磁性傳感器。
- 固定座** | PB-13用於固定LYD-07、LYD-29、LYD-36、LYD-81等系列的磁性傳感器。

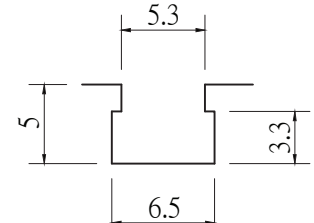

溝槽尺寸

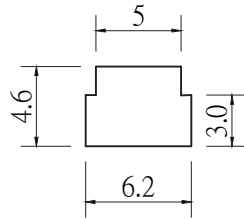
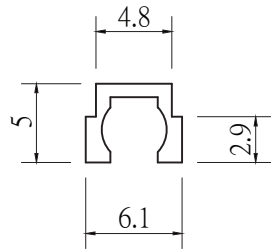
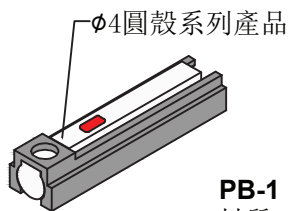
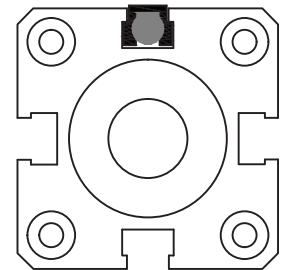
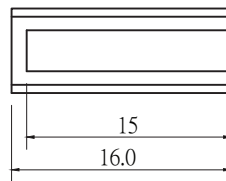
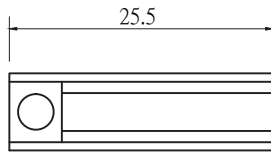

PB-1
材質：塑膠件

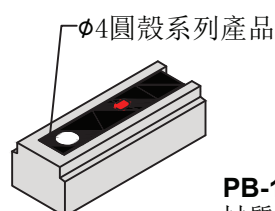

PB-13
材質：塑膠件

單位：mm

- PB-3** | T型槽轉換C型槽之固定座，適用於SMC尺寸溝槽。
- IB-03** | PB-3用於固定LYD-07、LYD-81、LYD-81V系列的磁性傳感器。
- 固定座** | IB-03用於固定LYD-07、LYD-29、LYD-36、LYD-81等系列的磁性傳感器。

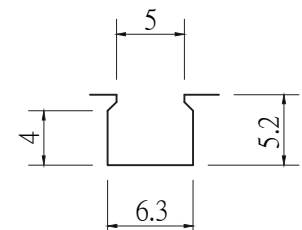
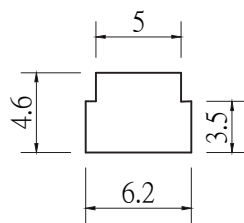
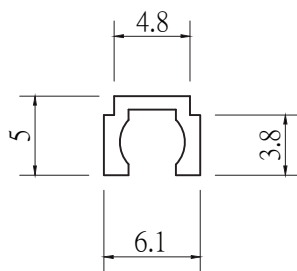

溝槽尺寸

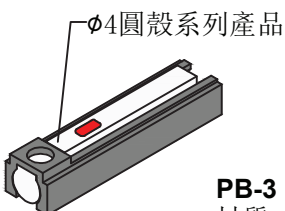
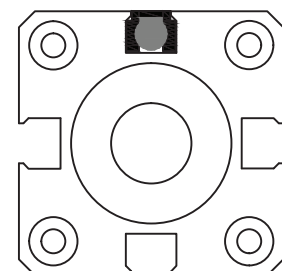
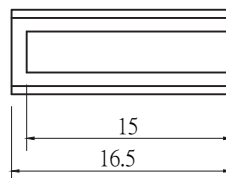
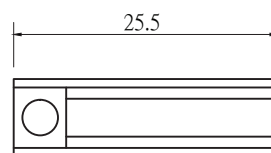

PB-3
材質：塑膠件

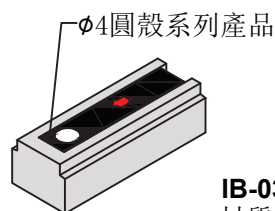

IB-03
材質：鋅合金件

單位：mm